

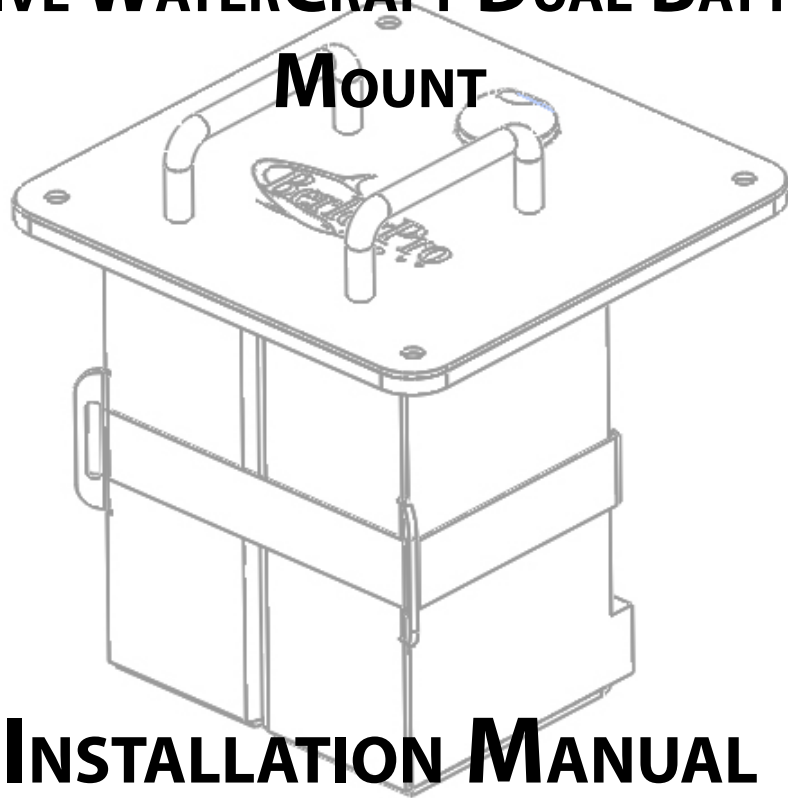

NATIVE WATERCRAFT DUAL BATTERY MOUNT



INSTALLATION MANUAL

BP610

This manual is to be used as a guide only. BerleyPro is not responsible for any damage or incidents that can occur during the installation or incorrect use of incorrectly assembled components. The information in this manual is strictly property of BerleyPro and can be changed at any time without notice. BerleyPro reserves the rights to change designs, materials and prices without notice. BerleyPro does not take any responsibility for manufacturers hull warranties.

NATIVE WATERCRAFT DUAL BATTERY MOUNT PARTS LIST

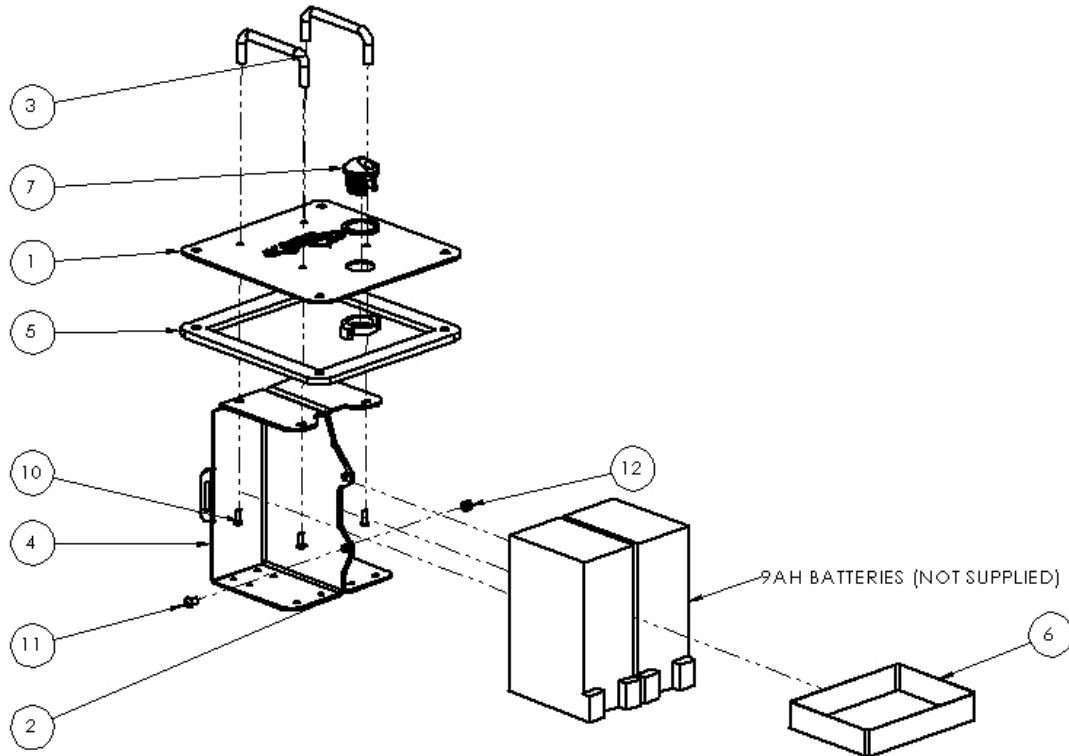

ITEM NO.	PART NUMBER	DESCRIPTION	QTY.
1	BP61014	Battery Mount Top	1
2	BP61024	RH Battery Cradle	1
3	BP61034	Handle	2
4	BP61044	LH Battery Cradle	1
5	BP61066	6mm EPDM Hatch Seal	1
6	BP61076	Velcro Strap	1
7	BP0012	Thru Hull Gland	1
FASTENERS			
10	M4 x 0.7 x 16 BHCS SS		4
11	M5 x 0.8 x 10 BHCS SS		1
12	M5 SS NYLOCK		1

INSTALLATION INSTRUCTIONS

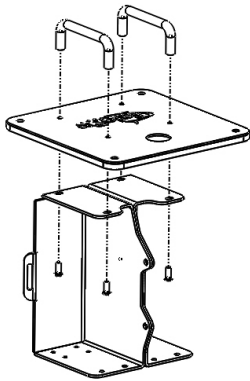

Place Loctite 246 or equivalent on the 4 M4 x 0.7 x 12 cap screws provided and screw them finger tight into the handles through the battery cradle and cover as shown.

1

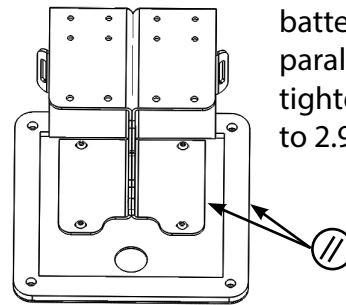

Ensure the edges of the battery cradle is running parallel with cover and tighten the 4 cap screws to 2.9 N*m

2

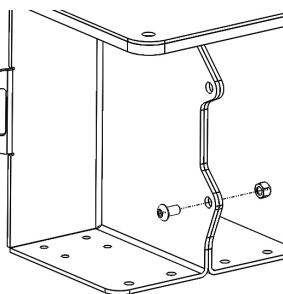

Install the M5 x 0.8 x 10 cap screw and nylock nut provided and torque to 5 N*m.

3

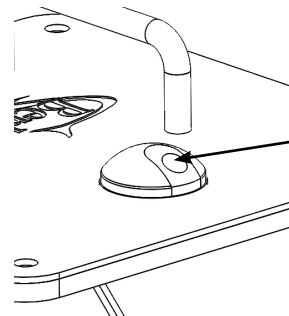

Choose one of the gromets provided the fits tightly around the cable or cables that you will be running through the gland.

4

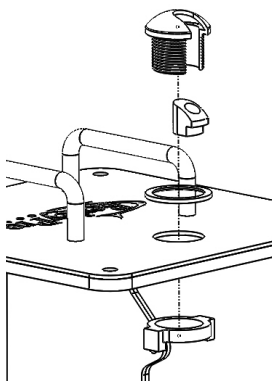

Place the cable through the black nut first, then through the cover and the seal. The top half of the gland is pushed down over the gromet and the nut is then done up finger tight on the rear.

5



Finally install your batteries into the two cradles. (DO NOT TOUCH THE EXPOSED TERMINALS ONTO THE ALUMINIUM MOUNTS). and then wrap the velcro around the back of the mount and batteries.

6