

BERLEYPRO

SWITCH MOUNT



INSTALLATION MANUAL

BP1404

This manual is to be used as a guide only. BerleyPro is not responsible for any damage or incidents that can occur during the installation or incorrect use of incorrectly assembled components. The information in this manual is strictly property of BerleyPro and can be changed at any time without notice. BerleyPro reserves the rights to change designs, materials and prices without notice. BerleyPro does not take any responsibility for manufacturers warranties.

INSTALLATION INSTRUCTIONS

Install your switch or switches into the BerleyPro switch mount as shown.

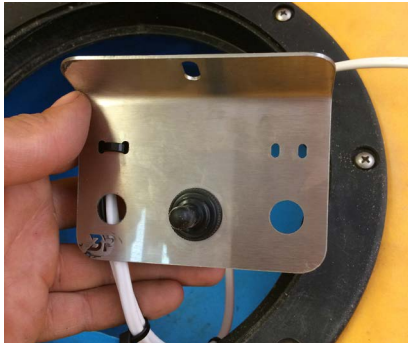

1

The 4 slots above the switches are used to cable tie your electrical connections off the base of the hull. Install a cable tie as shown.

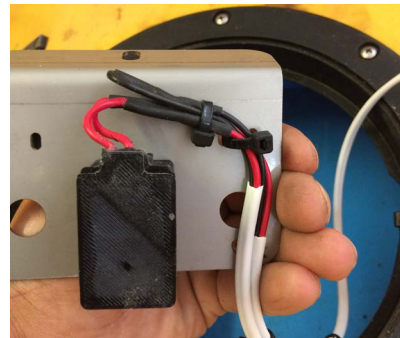

2

The switch mount is designed to be installed into a hatch using the original screw and wedged under the hatch backing plate as shown.

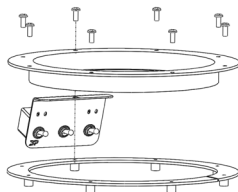

3

Firstly remove a screw in the location you want to locate the switch mount. It is best to loosen the screws on either side also to make it easier to install.



4

Install the mount with the re-tighten the screws.

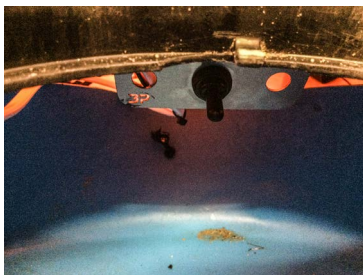

5