

BERLEYPRO

Native Watercraft LayFlat Rod Storage Installation BP6029

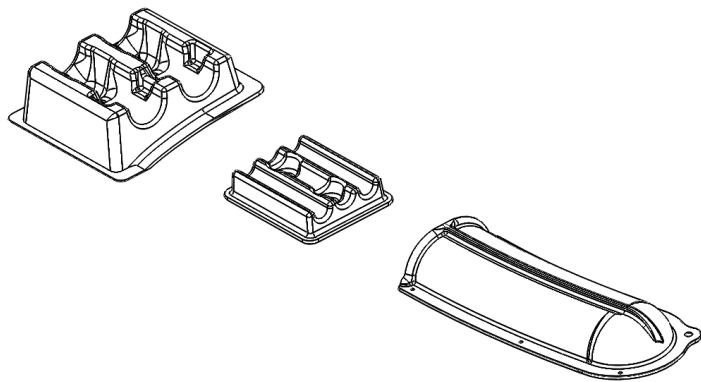

BerleyPro is not responsible for any damage incurred to the hull or persons while installing or using this part. This manual is to be used as a guide only.

BP6029 Installation Guide

Rod Length

We understand all rod lengths are different depending on the fishing you do or just your preferred length. There is not right and wrong place to put the components and they will vary depending on your rods so get creative and do what works!

Travelling with Rod Storage

This rod storage is designed for on water only. Do not leave your rods in while travelling on the road or to and from the water as we design parts for kayaking not for automotive transport.

Using the Rod Storage

The rod storage is designed to give you an option to lay 2 rods down on your kayak. As with any fishing we believe it is important to leash your valuables in case the unexpected happens. The rod storage provides a cavity to store your rod tips so they don't snag on trees or other objects while using your kayak. There are large areas of the rod still open to the elements so always take care when using these parts so no damage is to incur.

**FOR MORE INFORMATION EMAIL
ENQUIRIES@BERLEYPRO.COM**

1

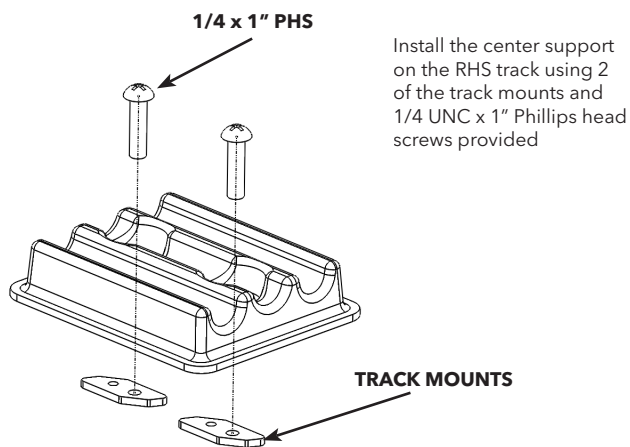

2

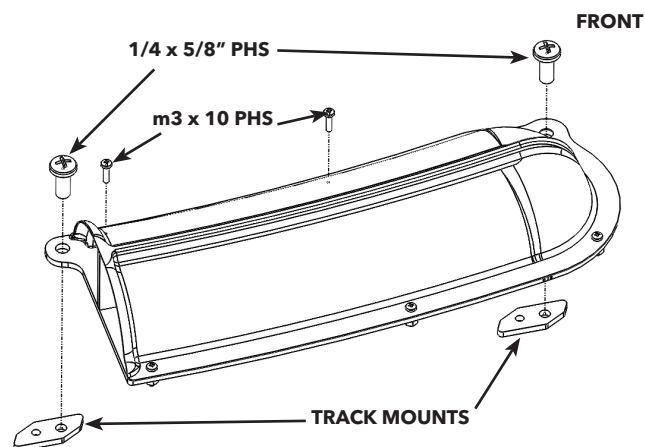

Installing the rod tip cover

Slayer 13 - Install the rod tip cover on the front RHS track using the 2 track mounts provided and 2 1/4 x 5/8" UNC phillips pan head screws.

Slayer 10 - Install the rod tip cover by first removing the two m3 x 10 phillips pan head screws as shown above. Install the rear track mount and screw in the track in front of the RHS propel thwart tube mount. Using 2 8 gauge screws where the m3 screws were removed into the kayak by slowly screwing them clockwise by hand and being careful not to over tighten. Use the larger 10 gauge screw in the front hole where the second track mount is shown.

Pictures are shown for slayer 10 and 13 on the next page.

BERLEYPRO

Native Watercraft LayFlat Rod Storage Installation BP6029

SLAYER 10



SLAYER 13



Installing the Rod Butt Holder

Depending on the length of your rods you have the option to move the rod butt holder to your liking. **Sit your rods in the mounts to get an idea of where you want to sit this mount before you go drilling into your kayak...** This can either be done by using 4 of the 10 gauge screws though the mount into the kayak or you can also track mount it by drilling 2 holes in the flange and using the 10/32 x 5/8" screws and track mounts provided.

Track Mounted



Mounted to Hull

